



15 Seafeld Road North, Caister, Great Yarmouth, NR30 5LE

£1,100 PCM





£1,100 PCM

15 Seafield Road North

Caister, Great Yarmouth, NR30 5LE

- Two Double Bedrooms
- Superb Kitchen Breakfast Room
- Garden
- Two Reception Rooms
- Study
- Ample Offstreet Parking

Aldreds Lettings are delighted to offer this exceptional, extended and improved 2 double bedroom detached bungalow situated in this sought after residential location within easy reach of the town centre and beach. The accommodation comprises of a large living room, superb modern kitchen breakfast room, utility room, stunning orangery, master bedroom and second double bedroom both with extensive fitted wardrobes, separate study room, bathroom with shower over the bath, delightful garden, ample off street parking and garage/store. Gas central heating, double glazing, Council Tax Band C, UNFURNISHED



Living Room 14'9" x 10'2" (4.5 x 3.1)

Large living room with big bay window, glazed double doors, quality wooden flooring, radiator.

Orangery 14'9" x 10'2" (4.5 x 3.1)

Very high quality orangery, triple aspect windows, glazed double doors to garden, wooden flooring, inset spotlights, radiators.

Kitchen Breakfast Room 15'1" x 8'6" (4.6 x 2.6)

Superb modern kitchen with ample storage and work surface including breakfast bar.. Appliances include electric hob, double oven, cooker hood, fridge/freezer and washing machine. Tiled floor, inset spotlights, door to utility room.

Utility Room

Separate utility room, space for additional appliances, door to garden.





Bedroom 1 18'8" x 8'10" (5.7 x 2.7)

Large double bedroom with dressing area, extensive fitted wardrobes, glazed double doors to garden, quality wooden floor, inset spotlights, radiator.

Bedroom 2 12'1" x 9'10" (3.7 x 3)

Second double bedroom, extensive fitted wardrobes, glazed doors to garden, radiator.

Bathroom

Modern white suite comprising bath with shower over, WC and wash basin. Chrome heated towel rail, frosted window, tiled floor, extensively tiled walls.

Study 11'5" x 10'5" (3.5 x 3.2)

Separate study room, glazed doors to garden, laminate floor, inset spotlights.

Garden

Superb landscaped private enclosed garden, extensively hard landscaped for easy maintenance, raised flower beds, outdoor dining area.

Directions



Parking & Garage Store

Ample private off street parking, gated driveway leading to garage (please note restricted width access to garage). This garage would be suitable for a small car and provides excellent storage.

Additional Information

RENT

Rent is exclusive of electricity, gas (unless otherwise specified), Council Tax, water rates, sewerage rates. The rent is payable monthly in advance.

TENANCY

6 Months Assured Shorthold.

TERMS

NO SMOKING

ADDITIONAL INFO

All applications for tenancy to be on a form which can be obtained from this office. A non-refundable holding deposit equivalent to one week's rent will be required. This will be transferred towards the first month's rent on commencement of the tenancy. The rent is payable monthly in advance and a Dilapidations deposit equivalent to 5 weeks' rent will also be required when agreements are signed. The Dilapidations Deposit is returnable after completion of a satisfactory tenancy. The aforementioned charges would be payable by bankers draft, a cheque drawn on a Building Society account, cash or Debit Card. NOT A PERSONAL CHEQUE.

Floor Plans

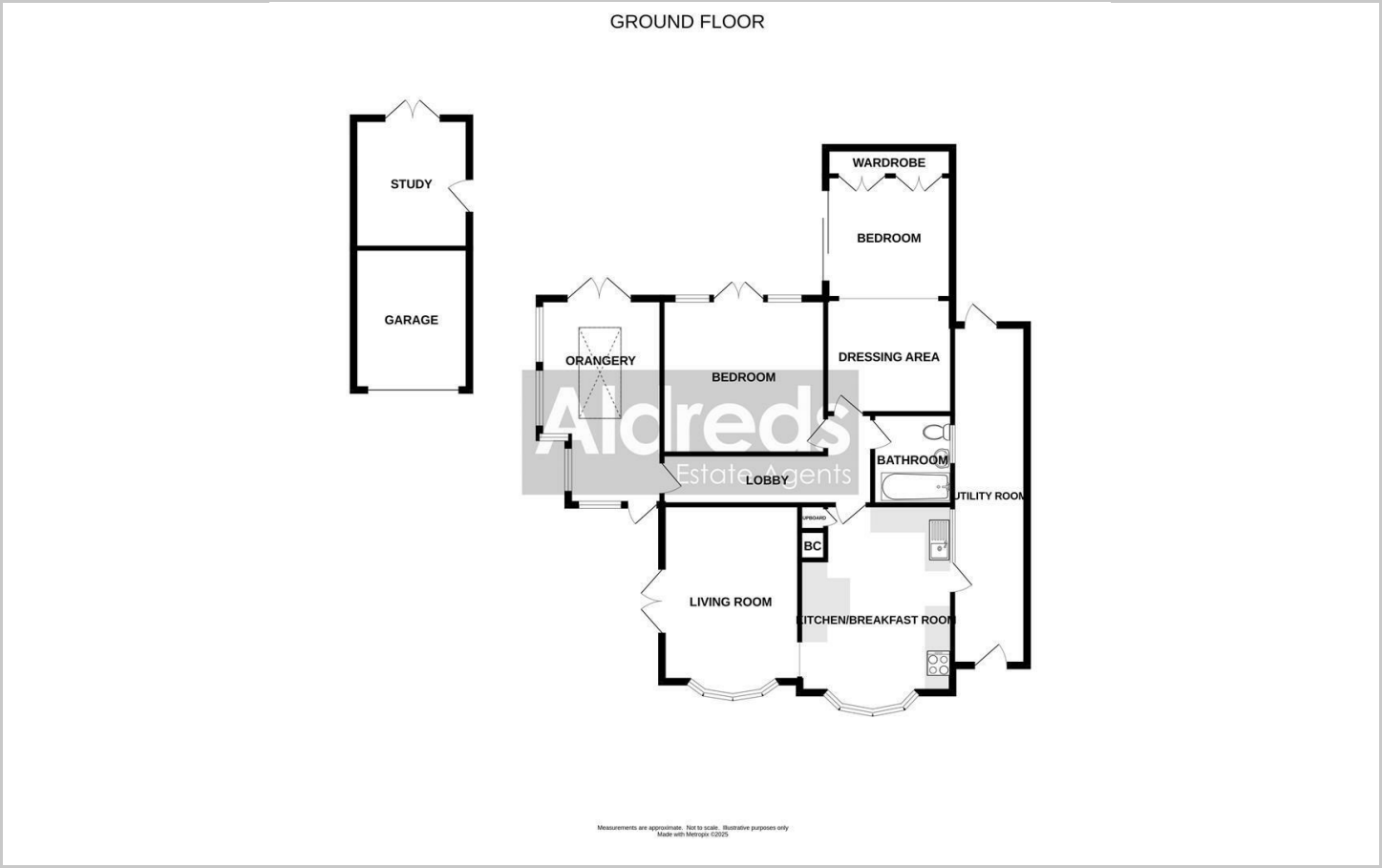

Location Map



Energy Performance Graph

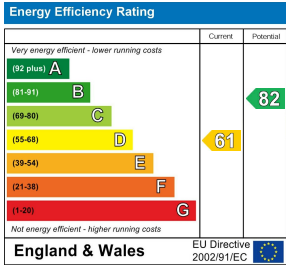

Viewing

Please contact our Aldreds Lettings Office on 01493 849111 if you wish to arrange a viewing appointment for this property or require further information.

Disclaimer
These particulars are issued on an understanding that all negotiations shall be conducted through Messrs. Aldreds. Please note: Messrs. Aldreds for themselves and for the vendors or lessors of this property whose agents they are given notice that: 1. Particulars are set out as a general outline only for guidance of intending purchasers or lessees, and do not constitute nor constitute part of, an offer or contract. 2. All descriptions, dimensions, references to condition and necessary permissions for use and occupation, and other details are given without responsibility and any intending purchasers or tenants should not rely on them as statements or representations of fact but must satisfy themselves by inspection or otherwise as to the correctness of each of them. 3. No person in the employment of Messrs. Aldreds has any authority to make or give any representation or warranty whatever in relation to this property. 4. If you are proposing to visit the property and are travelling some distance please check with Aldreds on the issue of availability prior to travelling. 5. Aldreds Property Consultants and associated services may offer additional services to the prospective purchaser for which they will be entitled to receive a commission. Aldreds are pleased to be working with Mortgage Advice Bureau. They're an award-winning mortgage broker with over 1,400 advisers across the UK, and have access to over 12,000 mortgage products from over 90 lenders. Aldreds Estate Agents Ltd receive a commission of £200 on each completed case. Your home may be repossessed if you do not keep up repayments on your mortgage. There may be a fee for mortgage advice. The actual amount you pay will depend upon your circumstances. The fee is up to 1%, but a typical fee is 0.3% of the amount borrowed. Mortgage Advice Bureau is a trading name of Mortgage Seeker Limited which is an appointed representative of Mortgage Advice Bureau Limited and Mortgage Advice Bureau (Derby) Limited which are authorised and regulated by the Financial Conduct Authority. Mortgage Seeker Limited Registered Office: Lovewell Blake, Sixty Six North Quay, Great Yarmouth, Norfolk, NR30 1HE. Registered in England Number: 03721415. 6. Potential purchasers should check with their providers that the broadband and mobile phone coverage they would require is available.